

INSECT-D-CUTOR

**FLYING INSECT
CONTROL PRODUCTS
FOR EVERY SITUATION**



Flying insect control for every situation

INSECT-O-CUTOR has been the technological leader in the development of electric fly killers since introducing the original UV light units in the UK in 1962. Originality of design, quality of manufacture and outstanding performance are just three of the reasons why more than a million units have now been installed in 40 countries world-wide.

The new range combines improved styling with extra power – the most effective INSECT-O-CUTORS ever made. Now a major breakthrough in flying insect control; the INSECT-O-CUTOR **WISE™** system provides all-round protection against food contamination.



C O N T E N T S

Product	Series name	Models	Market / Features	Page
Electric Fly Killers	Focus	F1, F2	Small retailers and kitchens for versatility	3
	Select	SE22, SE44	Medium/large retailers and kitchens for superb styling	4
	Industrial	IND41, IND61	Factory/warehouse for ultra-high performance	5
Glueboard Fly Killers	Discreet	D11 (HyGenie)	Hotel, dining and other discreet areas	6
		D301 (Large Uplighter)		
	Select	SE30, SE40	Medium/large retailers and kitchens for superb styling	6
	Industrial	IND35, IND45, IND65	Factory/warehouse for ultra-high performance	7
Lamps	Synergetic™		UVA-Green light technology	8
Traps	Smart		Integrated defence measures	9
Maintenance			Easy servicing and advice on siting	9
Flyscreens and Doors	Barrier		Customised installation and maintenance	10
WISE			All round protection from flying insects	12



INSECT-O-CUTORS use Synergetic™ UVA-Green lamps, scientifically proven to be 30% more effective than traditional UVA lamps – see page 8 for details.

Compact, high-performance models – unbeatable value

F1

USE Small retailers and kitchens



The Focus F1 is INSECT-O-CUTOR's smallest unit and has excellent area coverage. It is ideal for all kitchens up to 45 square metres.

A real value for money unit with high performance and robust quality.

SPECIFICATION

Approx coverage	45m ²
Lamp	1 x 11 Watt (1 x T11G)
Power consumption	22 Watt
Size	300 x 120 x 310mm
Weight	4.1kg
Finish	white polyester

F2

USE Small retailers and kitchens



Double the power of the F1, to cover kitchens and other areas up to 90 square metres.

At home in any surroundings this model combines value for money with extraordinary performance in a very compact unit.

SPECIFICATION

Area of coverage	90m ²
Lamps	2 x 11 Watt (2 x T11G)
Power consumption	42 Watt
Size	390 x 120 x 310mm
Weight	5.1kg
Finish	white polyester

Snap-in lamps for easy changing

FOCUS SERIES FEATURES

- High performance 11 Watt Synergetic™ UVA-Green lamps for enhanced insect attraction
- High performance self-cleaning killing grid (removable for easy cleaning of unit)
- Tool-free maintenance for ease of cleaning and lamp replacement – no loose fittings to misplace
- Safe electrical isolation when guard is removed
- Optional shatterproof lamps for 'glass-free' areas
- Can be wall mounted, ceiling suspended or free standing
- All metal construction with white polyester finish for strength and durability
- Approved to EN60335-2-59 (Insect Killers Safety Standard)
- **FIVE YEAR GUARANTEE** (excluding lamps)

Powerful models with stunning good looks

SE22

USE Medium/large retailers and kitchens



High performance combined with smooth lines. This model is ideal for all food preparation areas and especially suitable for situations where appearance is important. The newly designed guard has a large open area for greater light output. This together with an integral central 'V' design significantly increases performance, covering areas up to 150 square metres.

SPECIFICATION

Area of coverage	150m ²
Lamp	1 x 22 Watt (1 x T21G)
Power consumption	38 Watt
Size	385 x 140 x 430mm
Weight	7.5kg
Finish	two-tone white & soft green polyester or stainless steel

SE44

USE Medium/large retailers and kitchens



All the advantages of the SE22 and with twice the power. Stunning good looks have not been sacrificed for the extra performance, which increases area coverage to 300 square metres.

SPECIFICATION

Area of coverage	300m ²
Lamps	2 x 22 Watt (2 x T21G)
Power consumption	58 Watt
Size	600 x 140 x 430mm
Weight	10.5kg
Finish	two-tone white & soft green polyester or stainless steel

SELECT SERIES FEATURES

- High performance 22 Watt Synergetic™ UVA-Green circline lamps, for enhanced insect attraction
- Tool-free maintenance for ease of cleaning and lamp replacement – no loose fittings to misplace
- Large collection tray to ensure all insects are contained within the unit
- Safe electrical isolation when guard is removed
- Optional shatterproof lamps for 'glass-free' areas
- High performance self-cleaning killing grid (removable for easy cleaning of unit)
- Can be wall mounted, ceiling suspended or free standing (back plates included for wall mounting)
- Available in two tone white and soft green polyester finish or food grade stainless steel
- Approved to EN60335-2-59 (Insect Killers Safety Standard)
- Normal life of Select series is over 15 years – provided they are maintained correctly
- **FIVE YEAR GUARANTEE** (excluding lamps)

High performance and robustness for demanding situations

IND41

USE Factory/warehouse



Designed for ultimate performance in food processing and warehousing premises, abattoirs, breweries, bottling and packing plants.

Has a massive 350 square metres coverage and comes with shatterproof lamps as standard.

Suitable for wall mounting or ceiling suspension.

SPECIFICATION

Area of coverage	350m ²
Lamps	2 x 20 Watt (2 x T20S)
Power consumption	62 Watt
Size	690 x 240 x 490mm
Weight	12.5kg
Finish	white polyester or stainless steel

IND61

USE Factory/warehouse



Thanks to the extra lamp, the IND61 has an increased area coverage of 500 square metres. A newly designed guard for this series has a large open area for greater light output. This together with an integral central 'V' design significantly increases performance.

Suitable for wall mounting or ceiling suspension. (Shown left with optional large catch tray.)

SPECIFICATION

Area of coverage	500m ²
Lamps	3 x 20 Watt (3 x T20S)
Power consumption	95 Watt
Size	690 x 240 x 490mm
Weight (standard catch tray)	12.7kg
Finish	white polyester or stainless steel

INDUSTRIAL SERIES FEATURES

- High performance 20 Watt Synergetic™ UVA-Green lamps for enhanced insect attraction
- Tool-free maintenance for ease of cleaning and lamp replacement – no loose fittings to misplace
- Safe electrical isolation when the guard is opened
- Supplied with shatterproof lamps as standard for 'glass-free' areas
- High performance self-cleaning killing grid (removable for easy cleaning of unit)
- Built to splash-proof standards
- All-metal construction from Zintec steel with polyester powder coat finish. Also available in food grade stainless steel
- Optional large catch tray ensures all insects collected within the body of the unit
- Approved to EN60335-2-59 (Insect Killers Safety Standard)
- **FIVE YEAR GUARANTEE** (excluding lamps)

High performance alternative to Electric Fly Killers

When an alternative to electric fly killing grids is required, INSECT-O-CUTOR has a complementary range of glueboard fly killers. This includes units which are discreetly attractive, being particularly appropriate in sensitive areas such as hotel lobbies and dining areas. They are silent in operation and exceptionally easy to maintain.

DISCREET SERIES



D11 (HyGenie)

Indistinguishable from a wall light, the HyGenie is available in additional colours as an option and is ideal for lobbies and dining areas. It is silent in operation and caught insects are hidden from view.

SPECIFICATION

Area of coverage	25m ²
Lamp	1 x 11 Watt (1 x T11G)
Power consumption	18 Watt
Size	300 x 100 x 150mm
Weight	1.5kg
Finish	brushed stainless steel & colour options



D301 (Uplighter)

Covering an area of up to 40 square metres, the D301 is ideal for large lobbies, bars and dining areas.

SPECIFICATION

Area of coverage	40m ²
Lamp	1 x 15 Watt (1 x T15G)
Power consumption	21 Watt
Size	530 x 153 x 213mm
Weight	2.9kg
Finish	white polyester

SELECT SERIES



SE30

Combines an effective powerful glue board fly killer with stylish looks. Features a removable front cover for easy servicing. Can be installed vertically or horizontally and be wall-mounted or free-standing.

SPECIFICATION

Area of coverage	80m ²
Lamps	2 x 15 Watt (2 x T15G)
Power consumption	38 Watt
Size	520 x 120 x 345mm
Weight	6.5kg
Finish	two-tone black & soft green polyester



SE40

All the advantages of the SE30 but gives 50% greater coverage (shown in vertical freestanding position).

SPECIFICATION

Area of coverage	120m ²
Lamps	2 x 20 Watt (2 x T20G)
Power consumption	52 Watt
Size	670 x 120 x 345mm
Weight	7.5kg
Finish	two-tone black & soft green polyester

INDUSTRIAL SERIES



IND35

Designed for factory/warehouse situations, this unit has shatterproof lamps as standard. Superior Glueboard performance and easy installation, suitable for wall mounting or free standing.

SPECIFICATION

Area of coverage	120m ²
Lamps	2 x 15 Watt (2 x T15G)
Power consumption	38 Watt
Size	510 x 150 x 235mm
Weight	6.5kg
Finish	two-tone white & soft green polyester



IND45

The larger IND45 has increased 50% area of coverage with the same versatility as the IND35.

SPECIFICATION

Area of coverage	180m ²
Lamps	2 x 20 Watt (2 x T20G)
Power consumption	52 Watt
Size	660x 150 x 235mm
Weight	7.5kg
Finish	two-tone white & soft green polyester



IND65

The ultimate in Glueboard power, this unit is built to IP65 dustproof/waterproof specifications and covers a massive area of 400 square metres. Ceiling only mounting. Available in food grade stainless steel.

SPECIFICATION

Area of coverage	400m ²
Lamps	4 x 20 Watt (4 x T20S)
Power consumption	104 Watt
Size	690 x 205 x 400mm
Weight	12.0kg
Finish	two-tone white & soft green polyester

GLUEBOARD FEATURES

- High performance Synergetic™ UVA-Green lamps, for enhanced insect attraction
- Tool-free maintenance for ease of cleaning and lamp replacement – no loose fittings to misplace
- Shatterproof lamps standard on IND35, IND45 and IND65. Optional on other units
- Large capacity Glueboards with long-life adhesive
- All metal construction from Zintec steel with polyester powder coat finish. IND65 also available in food grade stainless steel
- Approved to EN60335-2-59 (Insect Killers Safety Standard)
- D11 (HyGenie) available in brushed stainless steel as standard. Other colours available to order
- **FIVE YEAR GUARANTEE** (excluding lamps)

Glueboards specially formulated to last up to 3 months

Synergetic™

UVA-Green light technology

All INSECT-O-CUTOR fly killers are fitted with the patented Synergetic™ UVA-Green lamp which combines two attractant phosphors to provide these important benefits:

- Catches common House flies, Blow flies and Fruit flies 30% faster than traditional UVA lamps (which appears blue to the human eye)
- Attracts a broader range of insects, including stored product moths, where lamps with only UVA light are less effective
- Keeps on working longer because the green light phosphor hardly ever degrades, unlike UVA lamps which lose up to 40% of their power after 6 months.

Fig. 1 shows the two wave length peaks for UVA-Green light.

Stored product **beetles** including tobacco beetle, lesser grain beetle, grain beetle, rice weevil; merchant grain beetle and confused flour beetle are attracted to the UVA spectral peak.

Stored product **moths**, including tropical warehouse moth, warehouse moth, Mediterranean flour moth and Indian meal moth are more attracted to the Green spectral peak. (Based on 'Review of the response of stored product insects to light of various wavelengths, with particular

reference to the design and use of light traps for population monitoring' by D P Rees, Trp.Sci.1985.25, 197-21.)

Common house flies, blow flies and fruit flies are more attracted to a combination of UVA and Green light. (Based on independent tests carried out by the Medical Entomology Centre at Cambridge in 1994.)

Fig. 2 shows the degradation of the UVA phosphor decreasing to output of 30% over 12 months and the green phosphor

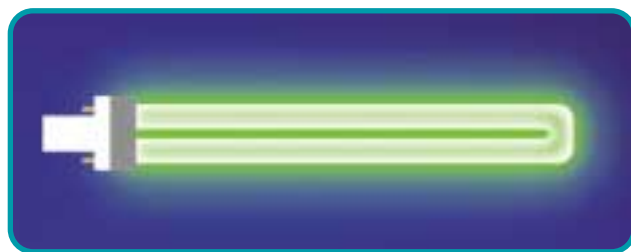

decreasing to output of 95% over the same period. (Based on tests by INSECT-O-CUTOR and manufacturer's information.)

All INSECT-O-CUTORs are fitted with Synergetic™ UVA-Green light as standard.

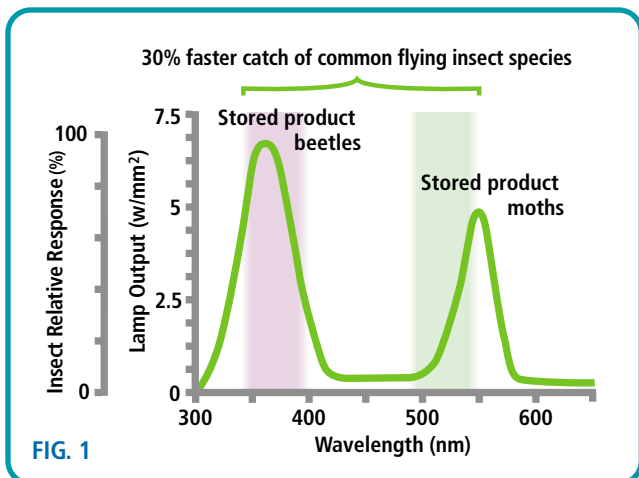

FIG. 1

UVA Green has two wavelength peaks attracting a broader range of flying insects.

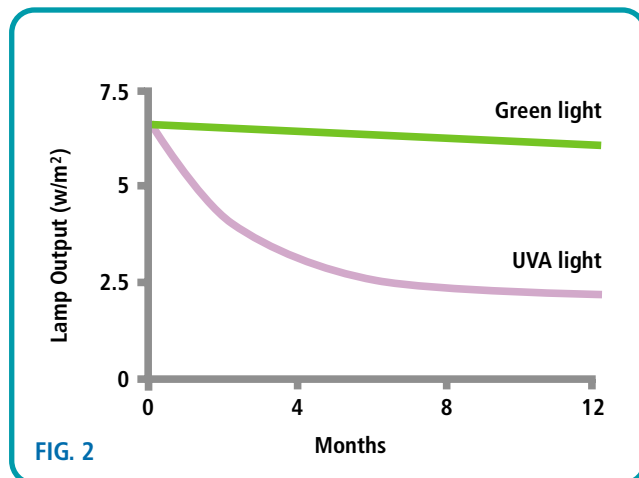

FIG. 2

Green light degrades much slower than UVA prolonging the lamp's effectiveness.

INSECT-O-CUTOR Smart traps are unique to the **WISE™** concept. They form part of an integrated defence system further enhancing the speed of insect elimination by electric fly killers.

Window trap



This glueboard trap works on the principle that once flies have entered a room they will often fly to the nearest window (a source of UV light). Window traps are easy to fix and have a hinged design for easy maintenance with a removable glueboard and pheromone/food lure.

Interceptor door trap



The Interceptor door trap works on the principle that flies normally fly upwards when entering a room. The trap is ceiling mounted with a removable glueboard and pheromone/food lure, both hidden from view.

M A I N T E N A N C E O F F L Y K I L L E R S

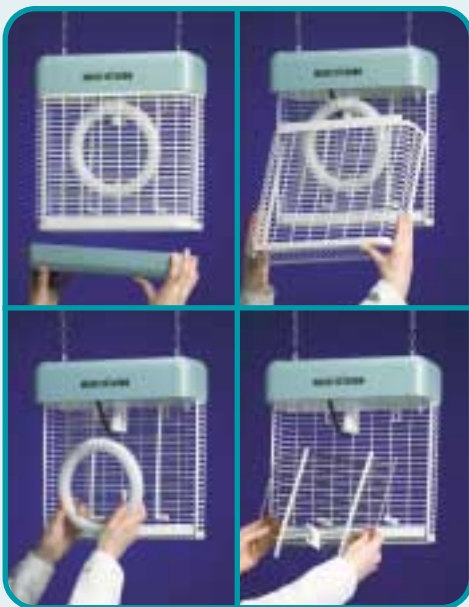

- All INSECT-O-CUTORS have tool-free maintenance
- Killing grids are self cleaning
- Glueboards should be changed at least every 3 months
- Lamps should be changed every 12 months

SERVICE SCHEDULE

As a minimum, the fly killer should be serviced annually:

- One minor service to clean the unit and check the electrical system
- one major service to change the attractant lamps, in addition to cleaning and checking the

TRANSFORMER INFORMATION

INSECT-O-CUTOR electric fly killers are fitted with a custom-built transformer providing a constant 4,000 volts. This prevents insects from sticking to the grid and ensures a most efficient method of eliminating flies.

electrical system. The body of the unit should only need occasional wiping over with a damp cloth and mild liquid detergent. Food-safe detergent that has no odour must be used in any food preparation or manufacturing area.

Remember to switch off and disconnect the electrical supply before starting work on the unit.

T I P S F O R I N S T A L L I N G E L E C T R I C F L Y K I L L E R S

1. The ideal location for an electric fly killer is at right angles to the major light source in the room
2. Avoid siting too high – ideally the base of the unit should be no more than 2 metres from the floor
3. Avoid siting the units where air currents can blow insects away from the units
4. Units must not be sited so that the light is obscured (if flying insects cannot see it the unit will not be very effective).
5. Avoid siting above food preparation areas
6. Site between potential entry points and production areas to intercept pests before they reach sensitive areas – see **WISE™** diagram on page 12
7. In areas with a particularly aggressive or wet atmosphere, it is recommended that all stainless steel units are used to prevent premature corrosion
8. For areas with a glass-free policy, use shatterproof lamps
9. And finally don't forget to change the lamp every 12 months – preferably just before start of the fly season!

Area of coverage is given as a guide only and other factors including the use of the area and the number of entry points should be taken into account when choosing a particular unit.

Comprehensive Solutions and Service

INSECT-O-CUTOR offers a wide range of professional quality flyscreening services designed to solve your entire flyscreening problems. Screens are individually tailored for any aperture and are of robust construction made to withstand the conditions in commercial and industrial premises. They are simple to remove to allow for regular cleaning. INSECT-O-CUTOR's factory trained installers have many years' experience in screening windows and doors in the food industry.



Hinged screen

Screens are made using a polyester powder coated aluminium frame covered with PVC coated fibreglass mesh which is fire retardant. The mesh is held

in place with a pliable rubber gasket designed to keep the mesh taut and secure. Screens are kept in place by retaining clips and can be easily removed for cleaning.



Sliding screen

Comprises two or three polyester coated aluminium flyscreens, each screen moving independently in the sliding channel of the framework

allowing easy movement and access to windows.



Centre pivot screen

A centre pivot window screened in two sections, one internal and one external. A 45° angled brush-strip completes the fly proof seal.



Box screen

Where the design of the window is complex (such as louvre windows) a made to measure aluminium box can be manufactured to ensure that the

window can still open with the screen in place.



Better quality images required



Fly screen door

A powder coated, heavy duty, aluminium framed door. The PVC coated fibreglass mesh, together with the aluminium amplimesh, gives strength and protection.

Push and kick plates fitted to the middle and base of the door add to durability and save money in the long term due to long life.



Better quality images required (incl. close up of screen)



Chain link screen

Provides an effective barrier against flying insects. Chain link screens can be very effective in situations where rigid screen doors cannot be used e.g. fire doors. They

are made of aluminium giving a clean, bright finish and non-rust durability. They are quick to install and are designed for easy access and are fully removable.



Mesh screen for domestic applications

INSECT-O-CUTOR is able to offer professional fly screening services for the domestic market. The screens supplied are of the same

quality as those produced for the demanding commercial and industrial markets.

FEATURES

- Free surveys carried out by our own experienced surveyors
- 5 year guarantee – our commitment to quality and service
- Nationwide coverage
- Factory made for absolute accuracy and no on-site disruption
- Factory trained installation engineers for a perfect installation
- Widest range of options to solve all your fly screening needs
- All metal frames for strength and durability
- Angled corner cleat for less stress on mesh giving the screen a longer life
- PVC coated fibreglass mesh, strong and durable

– will not run or crease. Fire retardant and unobtrusive

- Clean lines. Minimal space for entrapment of dirt. Easy to clean
- Easily removable for cleaning which complies with Food Safety regulations
- Flyscreen mesh is held in place by gasket, not glued or welded, so can easily be replaced if damaged
- INSECT-O-CUTOR offers a life-long maintenance guarantee for complete peace of mind

LIFE LONG MAINTENANCE GUARANTEE

All flyscreens and doors come with a maintenance guarantee. For a low annual service charge, the units are inspected every six months. Units are removed on site for cleaning and any faulty parts replaced at no cost. Flyscreens and doors can be kept in tip top condition for a lifetime.



WINGED INSECT SYSTEMATIC ELIMINATOR

The professional response

Maintaining high standards of food quality and hygiene are vital concerns for all our customers. INSECT-O-CUTOR **WISE™** is a major breakthrough in flying insect control and the professional response to the risk of food contamination.

Tailor made for every flying insect control

INSECT-O-CUTOR **WISE™** will work in all types of situations, so pest control can be undertaken with complete confidence.

Easy maintenance has been designed into all the components to ensure trouble free, uninterrupted protection as part of a professional pest control programme.

THE INSECT-O-CUTOR **WISE™** CONCEPT

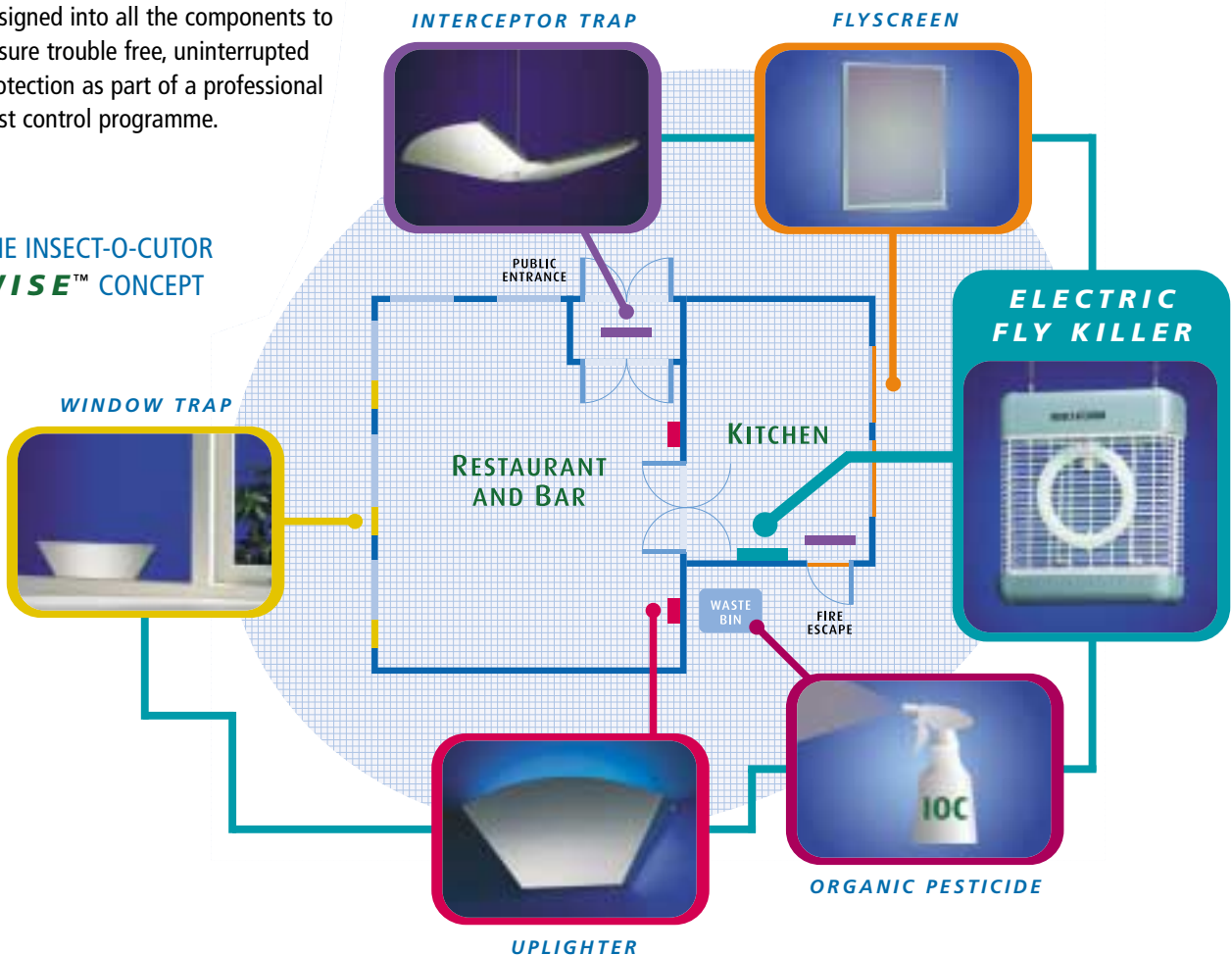

Reaping the benefits

INSECT-O-CUTOR **WISE™** provides a unique set of benefits:

- Multifaceted response to winged insect problems.
- Dramatically increases the speed of flying insect elimination.
- Fits every pest control situation, including organic food producer requirements.
- INSECT-O-CUTOR's high performing electric fly killers with the unique Synergetic™ UVA-Green light at the heart of every system.

The Process

Implementation of INSECT-O-CUTOR **WISE™** is based on a comprehensive risk assessment.

